

Memory Care

at Edgewood Mitchell



Memory Care - Designed for Balance

Edgewood's Memory Care residents live as independently as possible within a smaller, more comfortable home-like environment specifically designed to enhance sense of security and belonging. Alzheimer's disease, dementia and memory loss affect each individual differently. Our staff members have ongoing training to understand the conditions and challenges associated with this disease. Our staff-to-resident ratio allows us to provide more personal attention and help residents maintain daily living skills.

As people lose the ability to learn new things, Edgewood's staff members reaffirm what residents do remember, to improve self-esteem and reinforce positive experiences. Residents may assist in activities such as meal preparation, cleanup, folding laundry and other tasks. Edgewood Memory Care residents receive:

- 24-hour staffing with nurse coverage
- Care from staff members with specific training in Alzheimer's disease & memory care
- Safe, secure environment with secured doors & outdoor courtyard
- Three nutritious, home-cooked meals & snacks daily
- Individualized and small group activities
- Assistance with bathing, grooming & dressing
- Medication administration under nurse supervision
- Laundry & housekeeping services
- Arranged transportation to medical appointments
- Barbershop & beauty salon services
- Life Stations designed to spark past memories

Service Level

To simplify pricing structures Edgewood offers three levels of care based on each resident's current abilities and stage in their memory loss. This ensures our residents receive the appropriate level of care and support, whether that's through verbal cueing or hands-on care and assistance. The type of service level package is determined with a Registered Nurse (or designee as determined per state regulations) who completes a total resident evaluation.

Apartment rates

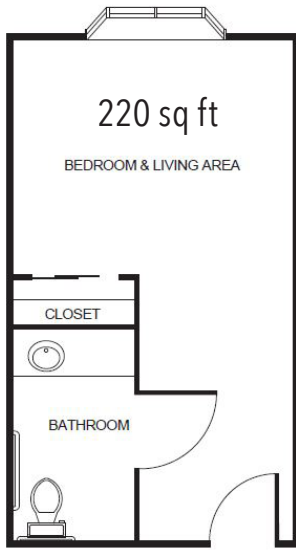

Studio

<i>Package One</i>	\$5,475
<i>Package Two</i>	\$5,875
<i>Package Three</i>	\$6,375

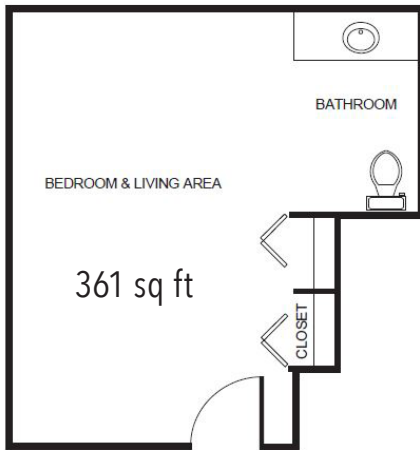

Companion

<i>Package One</i>	\$4,075
<i>Package Two</i>	\$4,475
<i>Package Three</i>	\$4,975

Additional rates

Community Service Fee (non-refundable)	\$750
Assisted Plus	\$300
Comfort Care Plus	\$550
Adult Day Services	\$15 per hour
Short Term Stay	\$200 per night